



Main

Range of product	Harmony XVC6
Accessory / separate part designation	Metal fixing plate
Accessory / separate part type	Fixing plate
Accessory / separate part category	Mounting and fixing accessories
Product compatibility	XVC6B1 XVC6B15S XVC6B2 XVC6B25S XVC6B3 XVC6B35S XVC6B4 XVC6B45S XVC6B5 XVC6B55S
Accessory / separate part destination	Complete pre-wired monolithic tower light
Product specific application	For support tube mounting

Complementary

Diameter	100 mm
Height	>= 30 mm
Product weight	0.08 kg

Offer Sustainability

Sustainable offer status	Not Green Premium product
RoHS (date code: YYWW)	Compliant - since 0808 - Schneider Electric declaration of conformity
REACH	Reference not containing SVHC above the threshold
Product end of life instructions	Need no specific recycling operations

The information provided in this documentation contains general descriptions and/or technical characteristics of the performance of the products contained herein. This documentation is not intended as a substitute for and is not to be used for determining suitability or reliability of these products for specific user applications. It is the duty of any such user or integrator to perform the appropriate and complete risk analysis, evaluation and testing of the products with respect to the relevant specific application or use thereof. Neither Schneider Electric Industries SAS nor any of its affiliates or subsidiaries shall be responsible or liable for misuse of the information contained herein.

Dimensions and Mounting

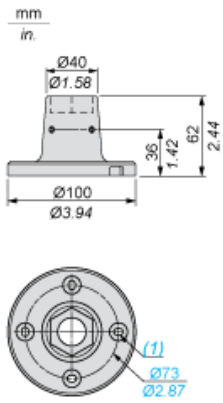

(1) 4 elongated holes Ø 4.2 mm x 5 mm / 0.16 in. x 0.20 in.