

XY2CE1A250

Emergency stop pull rope switch w/o tensioner - w/o pilot light

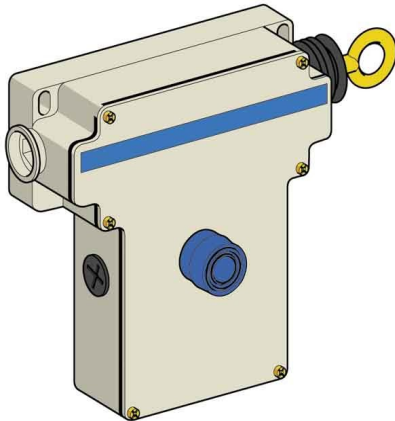

Main

Range of product	Preventa XY2
Product or component type	Latching emergency stop trip wire switch
Device short name	XY2CE
Local signalling	Without pilot light
Number of cables	1
Trigger cable maximum length	50 m
Housing colour	Grey RAL 7032
Reset	By booted pushbutton
Contacts type and composition	1 NC + 1 NO
Trigger cable anchor point	RH side
Connections - terminals	Screw clamp terminal 1 x 0.5...2 x 1.5 mm ²

Complementary

Contacts operation	Slow-break
Tightening torque	0.8...1.2 N.m
Cable entry	3 plain holes for Pg 13.5 cable gland
Mechanical durability	10000 cycles
Distance between cable supports	5 m
[I _e] rated operational current	3 A at 240 V AC-15, A600 conforming to EN/IEC 60947-5-1 appendix A 0.27 A at 250 V DC-13, Q600 conforming to EN/IEC 60947-5-1 appendix A
[I _{th}] conventional enclosed thermal current	10 A
[U _i] rated insulation voltage	300 V conforming to CSA C22-2 No 14 300 V conforming to UL 508 400 V, degree of pollution: 3 conforming to EN/IEC 60947-1
[U _{imp}] rated impulse withstand voltage	4 kV
Positive opening	With conforming to EN/IEC 60947-5-1 section 3
Resistance across terminals	<= 25 mOhm conforming to EN/IEC 60255-7 category 3 <= 25 mOhm conforming to NF C 93-050 method A
Short circuit protection	10 A cartridge fuse, gG conforming to EN/IEC 60269
Height	142 mm
Width	229 mm
Depth	105 mm
Terminals description ISO n°1	(11-12)NC (13-14)NO
Product weight	1.45 kg

Environment

Standards	EN/IEC 60947-5-1 EN/ISO 13850 UL 508
Product certifications	CCC CSA UL
Protective treatment	TC
Ambient air temperature for operation	-25...70 °C
Ambient air temperature for storage	-40...70 °C
Vibration resistance	10 gn (f = 10...300 Hz) conforming to EN/IEC 60068-2-6
Shock resistance	50 gn (11 ms) conforming to EN/IEC 60068-2-27
Class of protection against electric shock	Class I conforming to EN/IEC 61140 Class I conforming to NF C 20-030

The information provided in this documentation contains general descriptions and/or technical characteristics of the products contained herein. This documentation is not intended as a substitute for and is not to be used for determining suitability or reliability of these products for specific user applications. It is the duty of any such user or integrator to perform the appropriate and complete risk analysis, evaluation and testing of the products with respect to the relevant specific application or use thereof. Neither Schneider Electric Industries SAS nor any of its affiliates or subsidiaries shall be responsible or liable for misuse of the information contained herein.

